

Technical data sheet

DrainKleen® one shot

Condensate drain cleaner



Special Features

- Higher specific gravity than water

DrainKleen® one shot has been formulated specifically to clear organic blockages found in condensate drains within air conditioning and refrigeration units. It is a powerful and effective liquid drain cleaner which is the perfect size to treat a single condensate drain. The unique "swan neck" spout of the dispenser bottle allows for easy application of the product in awkward to reach condensate drains.

PRODUCT SPECIFICATION

Name	DrainKleen® one shot
Product Code	S010106GB, SO10146GB
Packing Quantity (ml, L)	12 x 250ml, 4 x 5 Litre
Packing Size (L x H x D cm)	22.5 x 18 x 20.5, 40 x 30 x 27
Shipping Weight (kg)	4.6, 27.52
Shipping Volume (m ³)	0.0112, 0.0324
Soils	Organic obstruction, rust deposits, limescale

Directions of use

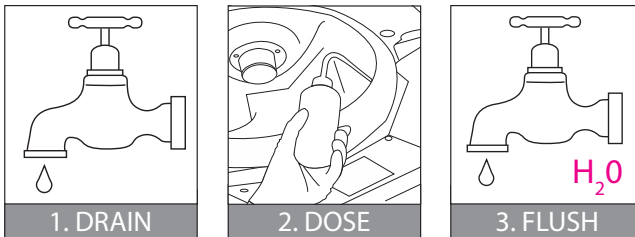

Remove excess water from condensate tray, and condensate drain, if possible. Gently pour DrainKleen® one shot into the tray and allow it to enter the drain. Allow DrainKleen® one shot to remain in the condensate tray and drain for five minutes or until obstruction is cleared. Flush out with fresh water for 2-3 minutes. Repeat as necessary until obstruction is cleared.

DrainKleen® one shot contains special inhibitors which control the cleaning action, making it safe to use on most metal, concrete and plastic surfaces. It is ideal for use in a planned preventative maintenance programme.



DrainKleen® one shot
UN1760
Danger
Contains: Sodium Hydroxide

H314: Causes severe skin burns and eye damage. P262: Do not get in eyes, on skin, or on clothing. P264: Wash hands thoroughly after handling. P280: Wear protective gloves / protective clothing / eye protection / face protection. P301+330+331: IF SWALLOWED: rinse mouth. Do NOT induce vomiting. P303+361+353: IF ON SKIN (or hair): Take off immediately all contaminated clothing. Rinse skin with water/shower. P305+351+338: IF IN EYES: Rinse cautiously with water for several minutes. Remove contact lenses, if present and easy to do. Continue rinsing.

Approved by



BlueDiamond™
 The only fit and forget condensate pumps

