

Technical Data Sheet

StayClean™ Strips

Condensate tray bacterial control



StayClean™ Strips are a condensate tray treatment providing up to six months' protection from bacteria, fungi, algae and other micro-organisms. The strips have a unique built-in inhibitor to protect equipment from rust and corrosion.

PRODUCT SPECIFICATION

Name	StayClean™ Strips
Product Code	S010310GB, S010307GB,
Packing Quantity (ml, L)	large 6 x 1, small 6 x 1
Packing Size (L x H x D cm)	9.5 x 15.4 x 2, 6.6 x 12.5 x 2
Shipping Weight (kg)	0.2, 0.1
Shipping Volume (m ³)	0.0005, 0.0005
Soils	Controls bacteria, mould & fungus

Special Features

- Provides up to 6 months' protection from micro-organism growth

Directions of use

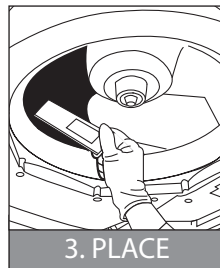
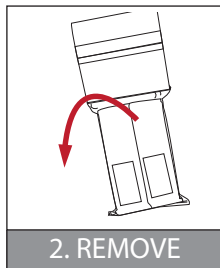

Simply place the strip in the tray at the highest end and adjacent to the coil so that the resulting treatment will cover the entire tray. If there is not sufficient space in the tray for the strip, it may be placed in the return bends at the end of the coil at the opposite end to the drain connection. Store in a cool, dry place.

Disposal

Product: Dispose of in a regulated landfill site or other method for hazardous or toxic wastes.

Packaging: Dispose of as normal industrial waste.

Preparation type: Solid

Biocide: Didecyl dimethyl ammonium chloride, 6 g/100 g

Alkyl (C12-16) dimethyl benzyl ammonium chlorides, 3.9 g/100g

Use biocides safely. Always read the label and product information before use.

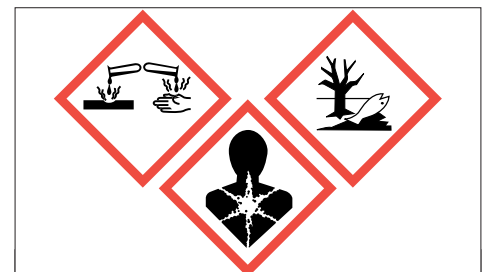

StayClean™ Strips
Danger
UN3244
Contains Biocide

H314: Causes severe skin burns and eye damage. H350: May cause cancer. H411: Toxic to aquatic life with long lasting effects. P264: Wash hands thoroughly after handling. P280: Wear protective gloves. P301+330+331: IF SWALLOWED: rinse mouth. Do NOT induce vomiting. P303+361+353: IF ON SKIN (or hair): Take off immediately all contaminated clothing. Rinse skin with water. P305+351+338: IF IN EYES: Rinse cautiously with water for several minutes. Remove contact lenses, if present and easy to do. Continue rinsing.

