



AIR CONDITIONING



REFRIGERATION



HEATING



UNIVOLT

Mini White

CONDENSATE REMOVAL PUMP

The 'ultra quick fit' Mini White is designed to be fitted beneath high wall indoor units and offers easy access for future maintenance. Now featuring universal voltage management.



CSI compliant



3.2 US Gal/h / 12L/h max. flow



33ft / 10m max. rec. head (flow rate 1 US Gal/h / 4L/h)



25dB(A)

KEY FEATURES

- Univolt
- Compact & discreet
- Clear removable reservoir

SUITABILITY

- Up to 4.5ton / 54,000Btu/h
- Ductless mini split systems
- ✓ **Perfect for...** Domestic use – where easy maintenance is key

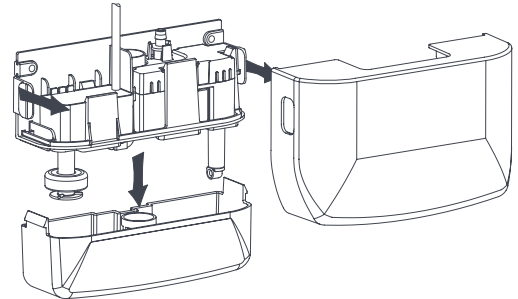
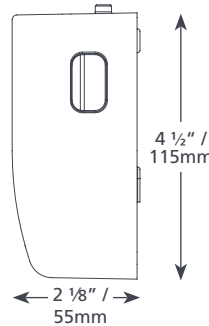
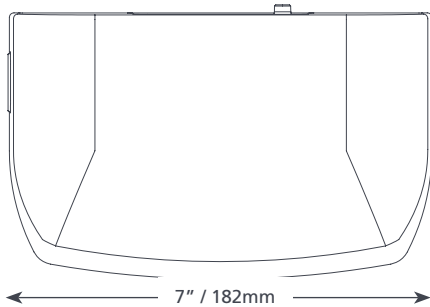

MINI WHITE UNIVOLT @ 60Hz

Max. flow @ 0 head	3.2 US Gal/h / 12L/h
Max. rec. head	33ft / 10m
Max. suction lift	n/a
dB(A) @ 3ft / 1m	25
Power supply	100-250 VAC, 0.17A, 19W, 50-60Hz
Rated	Non continuous
Class	II appliance <input type="checkbox"/>
Max. unit output	4.5ton / 54,000Btu/h
Max. water temp	104°F / 40°C
Inlet/outlet	3/4" / 20mm in, 1/4" / 6mm out
IP Protection	IP21
Safety switch	3.0A Normally closed
Thermal protection	✓
Fully potted	✓
Self priming	n/a

MINI WHITE UNIVOLT OPTIONS

Mini Blanc Univolt FP1058/RS

IN THE BOX

- Mini White Univolt pump (including hard wired 3ft / 1m power cable)
- Anti siphon device
- Drain connector kit
- Inline Fuse
- Fixing kit
- Install manual

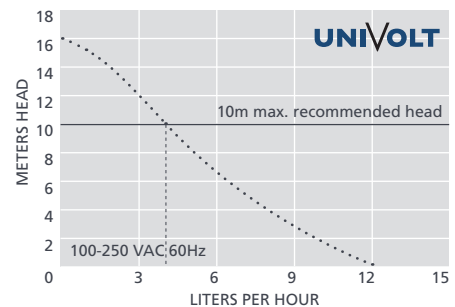
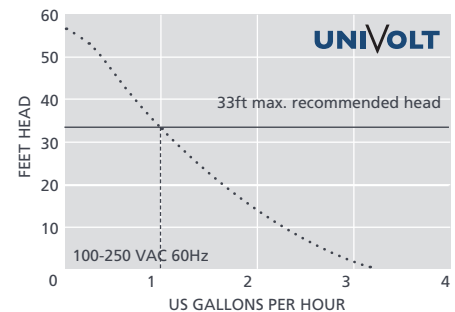

Information correct at time of going to press.

Download manual at aspenspumps.com

View install video at aspenspumps.com



aspenspumps.com

toll free (866) 772 2111

sales@aspenspumps.com

reliable | silent | simple